

6-QW-120(800A), 135F51



The product has excellent high-current discharge characteristics and is widely used in starting, ignition, and lighting systems. It uses a grid made of lead-calcium alloy, requires no maintenance or water addition during use, has a long power storage time, and a wide applicable temperature range

Picture



Dimension

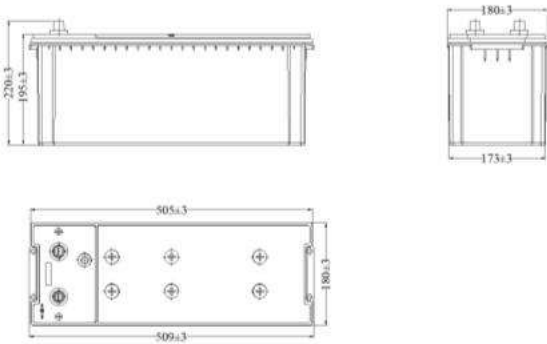

Specification

Nominal Voltage/V		12
Battery Weight/±3%kg		31.9
Rated Capacity/AH		120
Reserve Capacity/min		248
-18℃ CCA/A		800
Max Dimensions	Length/m	509
	Width/mm	180
	Height/mm	195
	Total Height/mm	220
CCA		900
Temperature	Discharge/℃	-40~+60
	Charge/℃	-40~+60
	Storage/℃	-40~+60
Optimal operating temperature/℃		+10~+30
Constant charging current/A		12.0
Constant charging voltage/V		13.5~13.8
Max charging current/A		36.0
Cover material		PP
Executive standard		GB/T 5008-2023

Terminal Dimension

Terminal Type	D/mm	
	Positive	Negative
T2	19.5 ⁺⁰ _{-0.3}	17.9 ⁺⁰ _{-0.3}

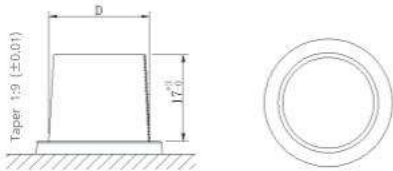

Discharge Curve/25℃



File Serial No.AKL/XC-6-QW-120T/01A